

### Features

1. Maximum reduction of power consumption is up to 75%.
2. Effectively reduce temperature rise of coil and extend service life of solenoid valve.
3. Quick response.
4. Stainless steel stem provides exceptional durability.
5. Flange type is available for JIS 10K, ANSI 150LB and PN16.
6. Timer for setting on/off time as optional accessory.
7. CE conformity.
8. Coil nut is available, please refer to page 5-3.
9. For power save connector, please refer to page 5-6.



### How to order

E-SPU220A	N	E	F	-	03	N	-	S7
Stainless steel Assisted Lift	Acting style Blank :Normally closed N :Normally open	Diaphragm Blank :VITON E :EPDM B :NBR H :HNBR	Flange type Blank :W/O Flange F :10K F3 :150LB F4 :PN16 only far A series		Port size 03 :3/8" 04 :1/2" 06 :3/4"	Thread Blank :G N :NPT R :Rc		Voltage S7 :12VDC S9 :24VDC

### How to order Repair kit

ZGPU220A	-	03	N	Description	Qty.
Repair kit				Diaphragm set	1
ZGPU220A (Normally closed)		03 :3/8", 1/2"	N :NBR V :VITON E :EPDM H :HNBR	Spring	1
ZGPU220AN (Normally open)		06 :3/4"		Packing	1

### Specifications

Model	E-SPU220A-03	E-SPU220A-04	E-SPU220A-06
Port size	3/8"	1/2"	3/4"
Fluid	Compressed air (light oil, water)		
Orifice	Ø13mm		Ø20mm
Effective area	76mm <sup>2</sup>		162mm <sup>2</sup>
Acting	Assisted Lift		
Construction	Diaphragm		
Operating pressure range DC	0 ~ 6 kgf/cm <sup>2</sup>		0 ~ 5 kgf/cm <sup>2</sup>
Proof pressure	10 kgf/cm <sup>2</sup>		
Body material / Flange material	Stainless steel SUS316 / SUS316, SUS304		
Fluid temperature	-10°C ~ 90°C		
Ambient temperature	-10°C ~ 60°C		
Installation	Horizontal		
Duty cycle	100% ED		
Coil type	DIN		
Protection class	IP65 (DIN 40 050)		
Insulation class	F		
Voltage tolerance	±10%		
Standard voltage	12VDC, 24VDC		
Power consumption	Power save 75% = 3.7W(4.6W option)		
Net weight	715g		920g

### Seal material selection guide

Seal	Temperature range	Suitable fluid	Unsuitable fluid
NBR	-15°C ~ 80°C	Air, Water, Neutral gases, Mineral oil	Fuel oil, Gasoline and Hi-test gasoline, Diesel fuel
HNBR	-40°C ~ 150°C	Air, Water, Gear oil, Engine oil	Pharmaceutical liquid, Gasoline and Hi-test gasoline, Light oil
VITON	-10°C ~ 180°C	Fuel oil, Gasoline and Hi-test gasoline, Diesel fuel	Hot water, Steam, Brake oil (ATE Blue)
EPDM	-5°C ~ 130°C	Hot water, Detergent liquid	Mineral oil, Gasoline

### Dimensions

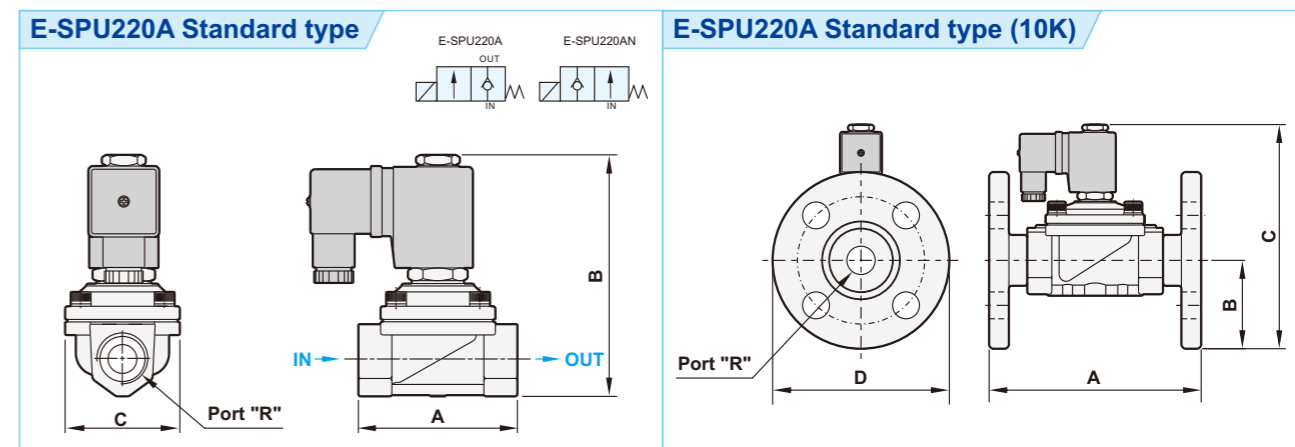

Model	E-SPU220A-03, 04			E-SPU220A-06	Model	E-SPU220AF-03, 04			E-SPU220AF-06
R	3/8"			3/4"	R	3/8"			3/4"
A	66.5			71	A	110			120
B	101			107	B	47.5			50
C	48			58	C	133			138.5
					D	95			100

### Explosion

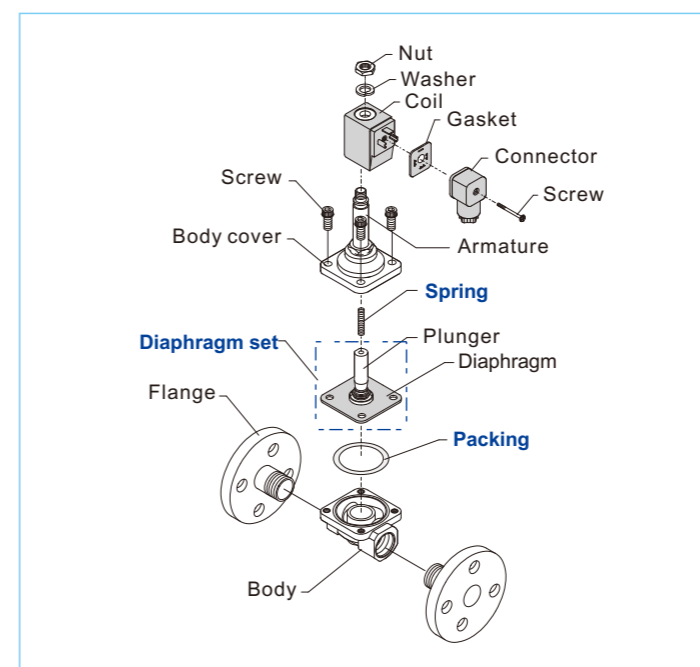

### Flow chart

