

### Features

1. Maximum reduction of power consumption is up to 75%.
2. Effectively reduce temperature rise of coil and extend service life of solenoid valve.
3. Quick response.
2. Stainless steel stem provides exceptional durability.
3. Flange type is available for JIS 10K, ANSI 150LB and PN16.
4. Timer for setting on/off time as optional accessory.
5. CE conformity.
6. Coil nut is available, please refer to page 5-3.
7. For power save connector, please refer to page 5-6.



### How to order

E-PU220A	N	V	F	—	03	N	—	S7
Brass	Acting style	Diaphragm	Flange type		Port size	Thread		Voltage
Assisted Lift	Blank :Normally closed N :Normally open	Blank :NBR V :VITON E :EPDM H :HNBR	Blank :W/O Flange F :10K F3 :150LB F4 :PN16 only for A series		03 :3/8" 04 :1/2" 06 :3/4" 08 :1"	Blank :G N :NPT R :Rc		S7 :12VDC S9 :24VDC

### How to order Repair kit

ZGPU220A	—	03	N	Description	Qty.
Repair kit		Port size	Diaphragm		
ZGPU220A (Normally closed)		03 :3/8", 1/2"	N :NBR	Diaphragm set	1
ZGPU220AN (Normally open)		06 :3/4" 08 :1"	V :VITON E :EPDM H :HNBR	Spring	1
				Packing	1

### Specifications

Model	E-PU220A-03	E-PU220A-04	E-PU220A-06	E-PU220A-08
Port size	3/8"	1/2"	3/4"	1"
Fluid	Compressed air (light oil, water)			
Orifice	Ø13mm	Ø13mm	Ø20mm	Ø25mm
Effective area	76mm <sup>2</sup>	76mm <sup>2</sup>	162mm <sup>2</sup>	220mm <sup>2</sup>
Acting	Assisted Lift			
Construction	Diaphragm			
Operating pressure range DC	0 ~ 6 kgf/cm <sup>2</sup>		0 ~ 5 kgf/cm <sup>2</sup>	
Proof pressure	10 kgf/cm <sup>2</sup>			
Body material / Flange material	Forged Brass / Steel SS41			
Fluid temperature	-10°C ~ 90°C			
Ambient temperature	-10°C ~ 60°C			
Installation	Horizontal			
Duty cycle	100% ED			
Coil type	DIN			
Protection class	IP65 (DIN 40 050)			
Insulation class	F			
Voltage tolerance	±10%			
Standard voltage	12VDC, 24VDC			
Power consumption	Power save 75% = 3.7W(4.6W option)			
Net weight	740g	740g	945g	1485g

### Seal material selection guide

Seal	Temperature range	Suitable fluid	Unsuitable fluid
NBR	-15°C ~ 80°C	Air, Water, Neutral gases, Mineral oil	Fuel oil, Gasoline and Hi-test gasoline, Diesel fuel
HNBR	-40°C ~ 150°C	Air, Water, Gear oil, Engine oil	Pharmaceutical liquid, Gasoline and Hi-test gasoline, Light oil
VITON	-10°C ~ 180°C	Fuel oil, Gasoline and Hi-test gasoline, Diesel fuel	Hot water, Steam, Brake oil (ATE Blue)
EPDM	-5°C ~ 130°C	Hot water, Detergent liquid	Mineral oil, Gasoline

### Dimensions

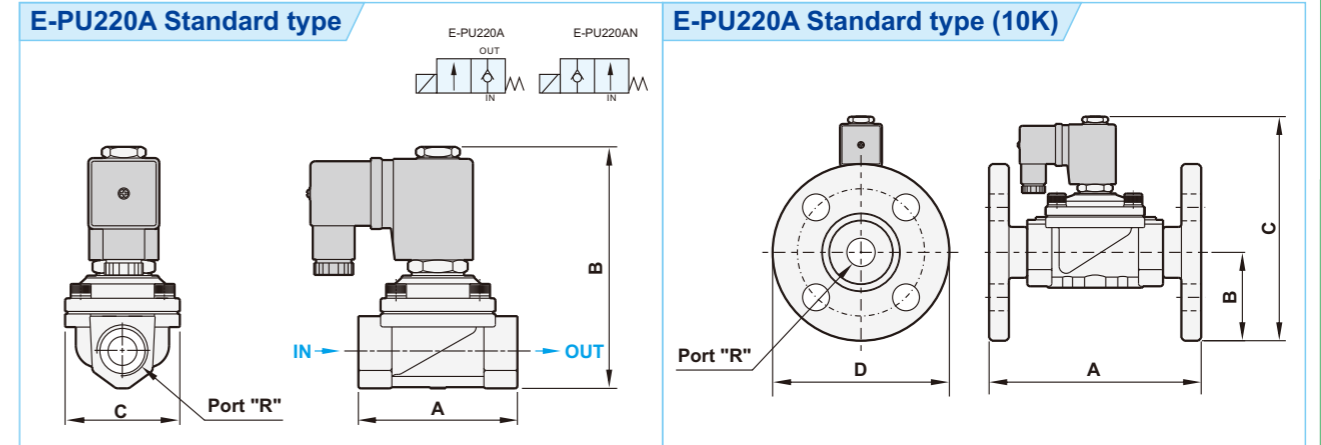

Model	E-PU220A-03	E-PU220A-04	E-PU220A-06	E-PU220A-08	Model	E-PU220AF-03	E-PU220AF-04	E-PU220AF-06	E-PU220AF-08
R	3/8"	1/2"	3/4"	1"	R	3/8"	1/2"	3/4"	1"
A	66.5	66.5	71	96	A	110	110	120	150
B	101	101	107	120.5	B	45	47.5	50	62.5
C	48	48	58	70.7	C	130.5	133	138.5	158.5
					D	90	95	100	125

### Explosion

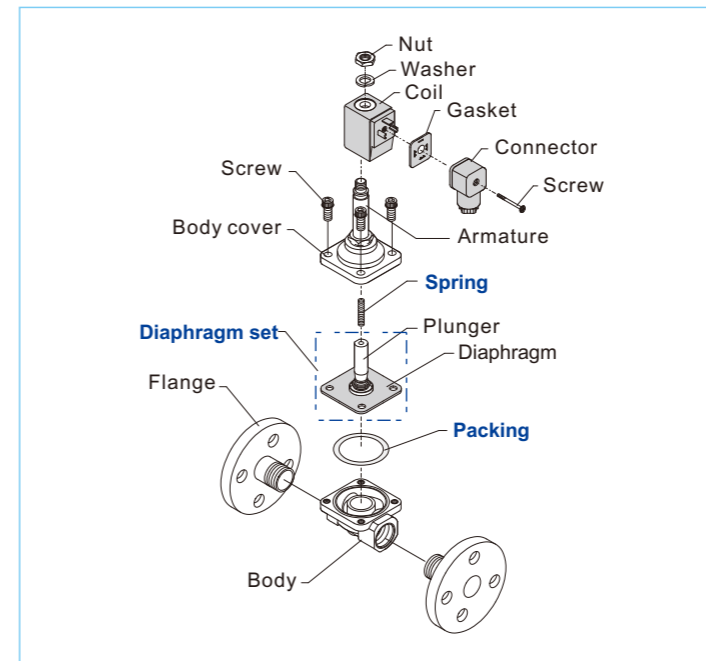

### Flow chart

